

# GRINDEX MAXI PUMPS (3 PCS)

TTR CODE NO. 70.002 – 70.004

## SPECIFICATIONS

50 Hz		MAXI N
Single phase (1), three phase (3)		3
Rated power	kW (hp)	37 (50)
Speed	r.p.m.	2900
Max. power consumption	kW	40
Rated current A	110V	-
" "	220V	116
" "	346V	74
" "	380V	67
" "	400V	64
" "	415V	61
" "	440V	58
" "	500V	51
" "	550V	47
Discharge connection	inch	8 (6)
Strainer holes	mm	12
Best total efficiency	.%	62
Weight	kg (lbs)	285 (628)
Height	mm (inch)	1290 (51)
Width, max.	mm (inch)	510 (20)
Strainer bottom Ø	mm (inch)	510 (20)

### Optional:

Hose socket with DN200 PN6 flange (L = 180 mm.)  
For 200 mm. hose (internal dia.)

### Optional:

Adaptor flange DN200 PN6 To DN200 PN10 (L = 270 mm.)

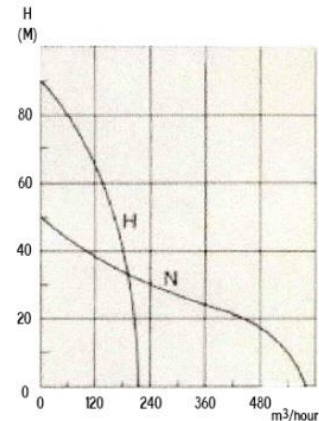
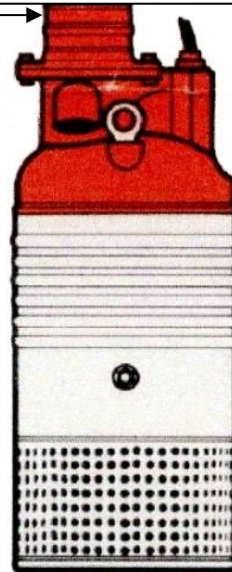
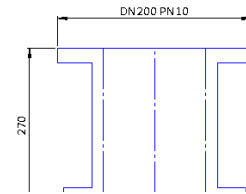

- The pumps can work without supervision.
- Only the larger types need a control cabinet.
- If the pumps run dry it's not a problem.
- Also, if the pump is out of water, cooling of the electric motor is guaranteed by the patented air valve.
- The pumps are equipped with an outer shell of corrugated steel, so they are resistant to a significant impact.
- The pumps are light in weight and easy to handle.
- Protection in the head of the pump protects the electric motor against damage from overheating and to almost all types of power failure.
- The pump casing is rubber coated.
- Top flange: DN200 PN6 (t = 30 mm.)

No details guaranteed but believed correct.